

205D/30 Barr St, Camperdown, NSW

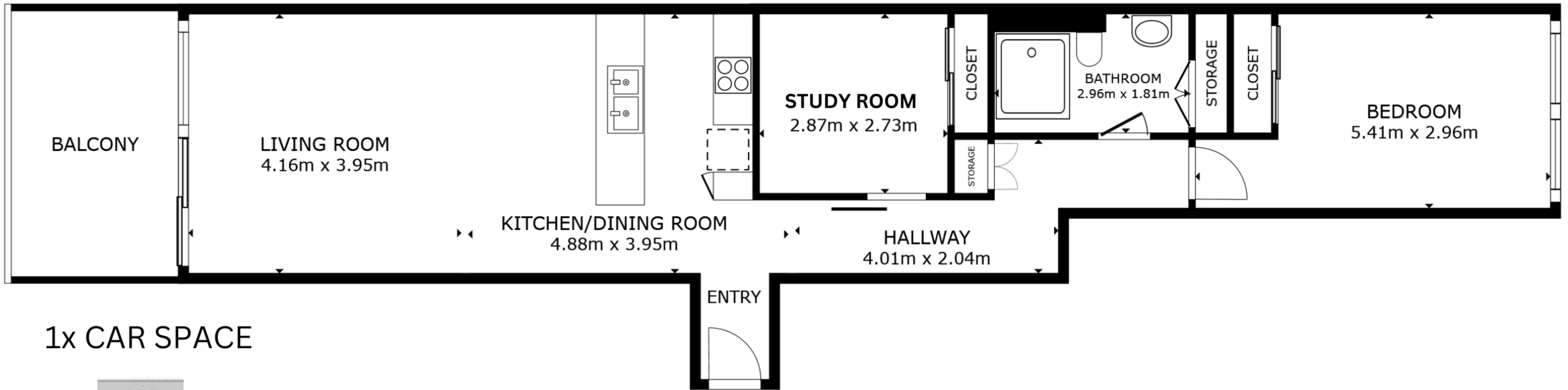

1x CAR SPACE

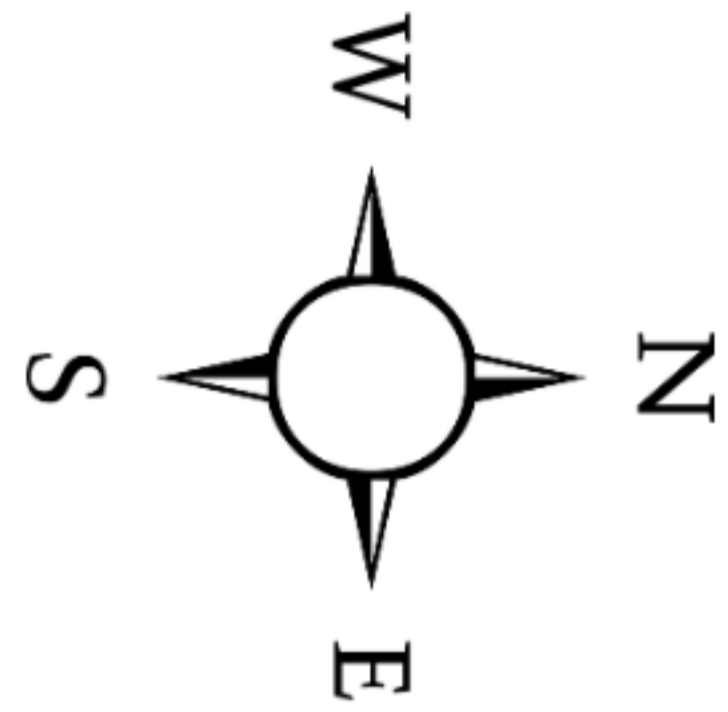

1x STORAGE



FLOOR PLAN

Apartment size: 85 sqm

1 Car space & 1 Storage: 16sqm

Total Area On Strata Title: 101 sqm

All dimensions and sizes on this floor plan are approximate, please refer to contract for exact measurements.

